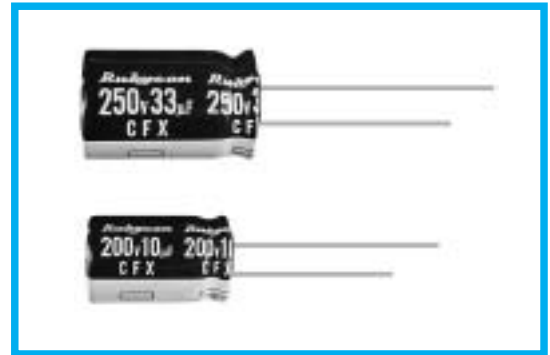

CFX SERIES
Load Life: 105°C 5000 Hours.
◆FEATURES

- High Ripple Current
- For Electronic Ballast, Power Supply
- RoHS compliance.

◆SPECIFICATIONS

| Items | Characteristics | | |
|--|---|---|--|
| Category Temperature Range | -25~+105°C | | |
| Rated Voltage Range | 200~400V.DC | | |
| Capacitance Tolerance | ±20% (20°C, 120Hz) | | |
| Leakage Current(MAX) | CV ≤ 1000 | CV > 1000 | I=Leakage Current(μA) C=Rated Capacitance(μF) V=Rated Voltage(V) |
| | I=0.1CV+40μA (1 minute) I=0.03CV+15μA (5 minute) | I=0.04CV+100μA (1 minute) I=0.02CV+25μA (5 minute) | |
| Dissipation Factor(MAX) (tan δ) | Rated Voltage (V) | 200 250 350 400 | (20°C, 120Hz) |
| | tan δ | 0.15 0.15 0.20 0.20 | |
| Endurance | After applying rated voltage with rated ripple current for 5000 hrs at 105°C, the capacitors shall meet the following requirements. | | |
| | Capacitance Change | Within ±20% of the initial value. | |
| | Dissipation Factor | Not more than 200% of the specified value. | |
| Leakage Current | Not more than the specified value. | | |
| Low Temperature Stability Impedance Ratio(MAX) | Rated Voltage (V) | 200 250 350 400 | (120Hz) |
| | Z(-25°C)/Z(20°C) | 3 3 6 6 | |

◆MULTIPLIER FOR RIPPLE CURRENT

Frequency coefficient

| Frequency (Hz) | 120 | 1k | 10k | ≥100k |
|----------------|-----|-----|-----|-------|
| 2.2~4.7 μF | 0.2 | 0.4 | 0.8 | 1.0 |
| 6.8~10 μF | 0.3 | 0.6 | 0.9 | 1.0 |
| 22~100 μF | 0.5 | 0.8 | 0.9 | 1.0 |

◆PART NUMBER

| | | | | | | |
|---------------|--------|-------------------|-----------------------|--------|--------------|-----------|
| □□□ | CFX | □□□□□ | □ | □□□ | □□ | D×L |
| Rated Voltage | Series | Rated Capacitance | Capacitance Tolerance | Option | Lead Forming | Case Size |

◆ DIMENSIONS

(mm)

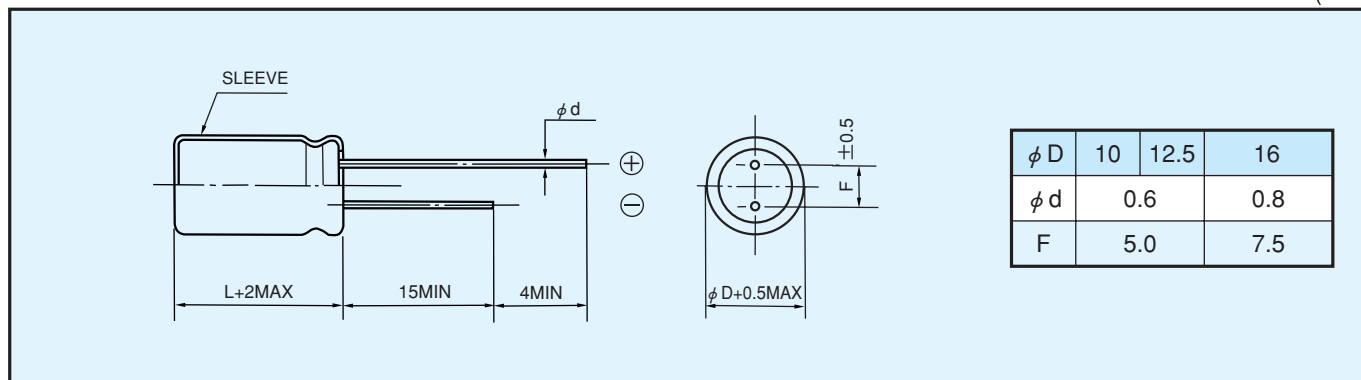
◆ STANDARD SIZE, RATED RIPPLE CURRENT

 Size $\phi D \times L$ (mm), Ripple Current (mA r.m.s./105°C, 100kHz)

| WV (V.DC) Cap (μF) | 200V (2D) | | 250V (2E) | |
|------------------------------|--------------|--------|--------------|--------|
| | Size | Ripple | Size | Ripple |
| 10 | 10×16 | 300 | 10×16 | 300 |
| 22 | 10×16 | 360 | 10×20 | 500 |
| 33 | 10×20 | 500 | 12.5×20 | 600 |
| 47 | 12.5×20 | 660 | 12.5×25 | 720 |
| 68 | 12.5×25 | 760 | 16×25 | 920 |
| 100 | 16×25 | 1120 | | |

| WV (V.DC) Cap (μF) | 350V (2V) | | 400V (2G) | |
|------------------------------|--------------|--------|--------------|--------|
| | Size | Ripple | Size | Ripple |
| 2.2 | | | 10×16 | 160 |
| 3.3 | 10×16 | 180 | 10×16 | 180 |
| 4.7 | 10×16 | 220 | 10×16 | 220 |
| 6.8 | 10×16 | 220 | 10×16 | 220 |
| 10 | 10×20 | 280 | 10×20 | 280 |
| 22 | 12.5×20 | 350 | 12.5×25 | 430 |
| 33 | 12.5×25 | 430 | 16×25 | 640 |
| 47 | 16×25 | 660 | | |