

LOW VOLTAGE RECTIFIER Transformer  
with horizontal channel frames.

- Primary voltage, 115 Volts, 60 Hz.
- Primary and secondary leads 8-10" long.
- 2-hole horizontal mounting.
- 5 sizes are available, covering the range: 10 to 50 VA.
- CSA listed (LR 47366).

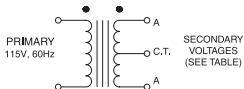

## MECHANICAL

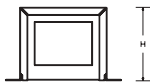
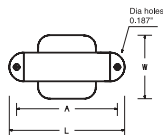

Dimensions, Inches

P/N	DIMENSIONS			PIN SPACING A
	L	W	H	
4766	3.25	2.00	2.00	2.81
4767	3.25	2.25	2.00	2.81
4768	3.69	2.13	2.31	3.13
4769	4.00	2.25	2.63	3.56
4770	4.00	2.50	2.63	3.56

## ELECTRICAL SPECIFICATION

Part No.	Secondary Voltages (A-A)		
	F.L. Volts	N.L. Volts	Current Amps
4766-01	6.3	7.25	1.20
4766-02	6.3	7.14	2.00
4766-03	10.0	11.00	1.00
4766-04	14.0	16.00	1.00
4766-05	20.0	22.00	0.50
4766-06	28.0	32.00	0.50
4766-07	30.0	34.20	0.50
4766-08	36.0	39.40	0.30
4766-09	44.0	50.60	0.25
4766-10	50.0	57.00	0.30
4767-01	8.5	9.60	2.00
4767-02	36.0	40.00	0.50
4767-03	16.0	17.60	1.00
4768-01	6.3	6.90	4.00
4768-02	8.5	9.50	3.00
4768-03	10.0	10.80	2.00
4768-04	12.6	13.80	2.00
4768-05	20.0	22.00	1.00
4768-06	25.0	27.50	1.00
4768-07	28.0	30.80	1.00
4768-08	44.0	48.10	0.50
4768-09	50.0	55.00	0.50

Part No.	Secondary Voltages (A-A)		
	F.L. Volts	N.L. Volts	Current Amps
4769-01	14.0	15.30	2.00
4769-02	18.0	19.60	1.50
4770-01	8.5	9.04	4.00
4770-02	10.0	10.50	3.00
4770-03	16.0	17.00	2.20
4770-04	16.0	17.40	3.00
4770-05	20.0	21.40	2.00
4770-06	25.0	26.80	1.50
4770-07	33.0	35.00	1.00
4770-08	36.0	39.50	1.00
4770-09	44.0	47.40	1.00
4770-10	50.0	54.50	1.00
4770-11	60.0	65.20	0.50
4770-12	80.0	85.50	0.50
4770-13	100.0	107.00	0.50
4770-14	120.0	129.50	0.30