

SUB-MINIATURE SMT PUSHBUTTON SWITCHES



**SPECIFICATIONS**

Rating:	100mA @ 50 VDC
Mechanical Life:	50,000 cycles typical
Contact Resistance:	80mΩ max. typical @ 2-4 VDC
	100mA
Insulation Resistance:	100MΩ min.
Dielectric Strength:	>1,000 Vrms at sea level
Operating Force:	50 ± 25 gf

**MATERIALS**

Housing:	4/6 Nylon
Actuator:	6T Nylon
Cover:	Stainless steel
Contacts:	Silver plated phosphor bronze
Terminals:	Silver plated brass
Spring:	Stainless steel

HOW TO ORDER

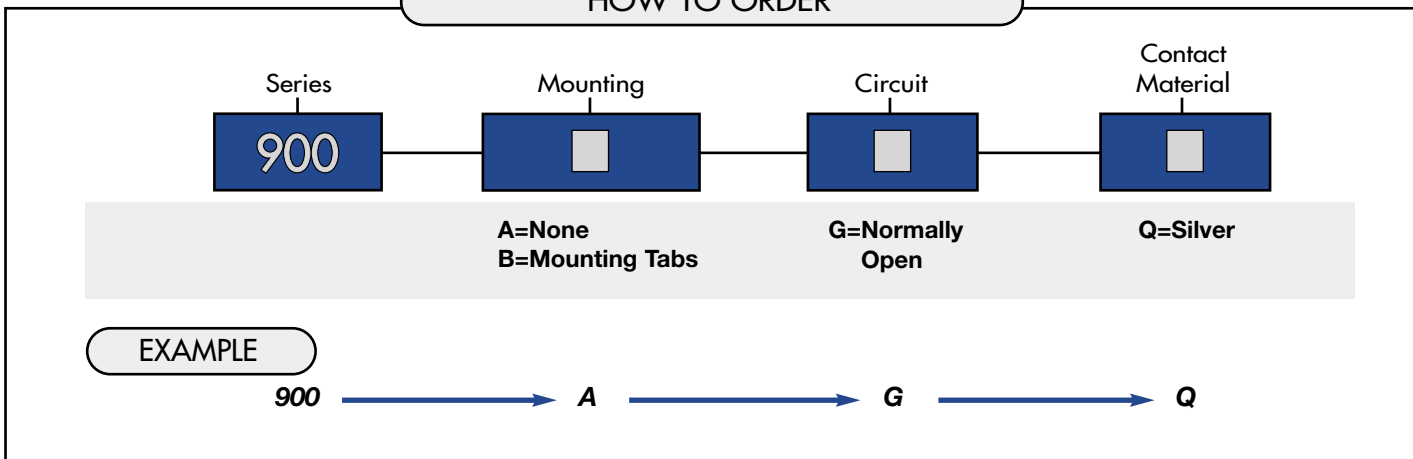

SPECIFICATIONS SUBJECT TO CHANGE WITHOUT NOTICE.

P.C. MOUNTING

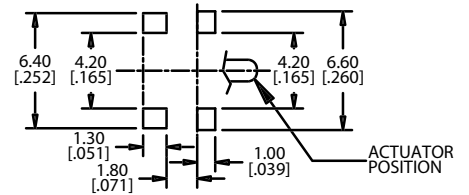
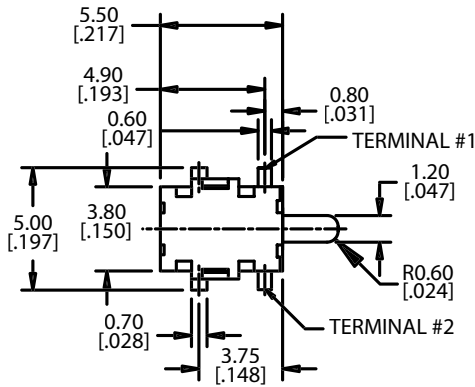

Schematic

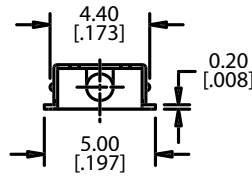
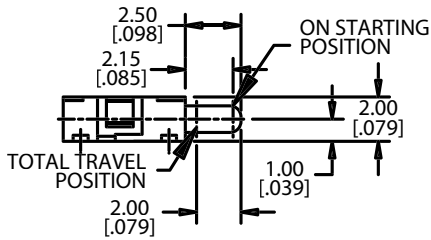
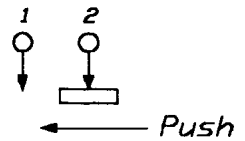

P.C. MOUNTING

WITH MOUNTING TABS

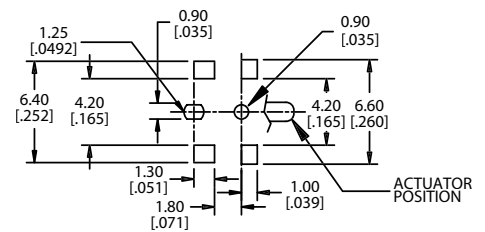

Schematic

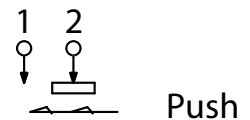

SPECIFICATIONS SUBJECT TO CHANGE WITHOUT NOTICE.

900 SMT TAPE AND REEL

