

Agilent HLMP-1050 T-1 (3mm) Right Angle Mount Housing

Technical Data

Features

- Fits Any Agilent High Dome T-1 LED Lamp
- Snap-In Fit Makes Mounting Simple
- High Contrast Black Plastic
- May Be Ordered with Mounted T-1 Lamp as an Option.
- Housing meets UL94V-0 Flammability Rating

Description

The HLMP-1050 is a black plastic right angle housing which mates with Agilent high dome T-1 lamps. The leads should be prebent 90° as shown prior to snapping into the right angle housing.

The housing material is high temperature nylon capable of withstanding temperatures up to +150°C.

Physical Dimensions

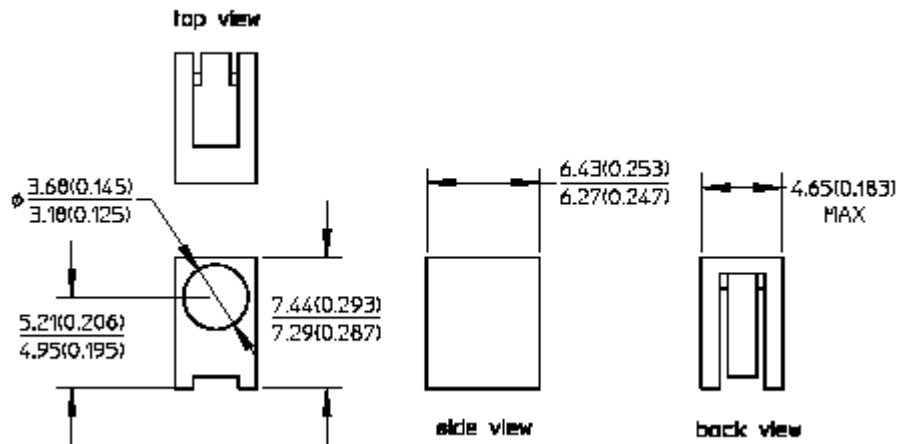

NOTES: ALL DIMENSIONS ARE IN MILLIMETERS (INCHES).

Option No.	Cathode Lead Length	Anode Lead Length	
A1	16.0 (0.630)	1.27 (0.050)	Unsheared Uneven Leads
A2	3.43 (0.135) Min.	3.43 (0.135) Min.	Sheared Even Leads

www.agilent.com/semiconductors

For product information and a complete list of distributors, please go to our web site.

For technical assistance call:

Americas/Canada: +1 (800) 235-0312 or
(916) 788-6763

Europe: +49 (0) 6441 92460

China: 10800 650 0017

Hong Kong: (+65) 6756 2394

India, Australia, New Zealand: (+65) 6755 1939

Japan: (+81 3) 3335-8152 (Domestic/International), or 0120-61-1280 (Domestic Only)

Korea: (+65) 6755 1989

Singapore, Malaysia, Vietnam, Thailand,
Philippines, Indonesia: (+65) 6755 2044

Taiwan: (+65) 6755 1843

Data subject to change.

Copyright 2003 Agilent Technologies, Inc.

January 13, 2004

5989-0518EN



Agilent Technologies