

QSB34GR, QSB34ZR

PACKAGE DIMENSIONS, QSB34GR

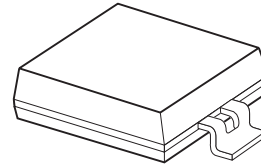

SCHEMATIC

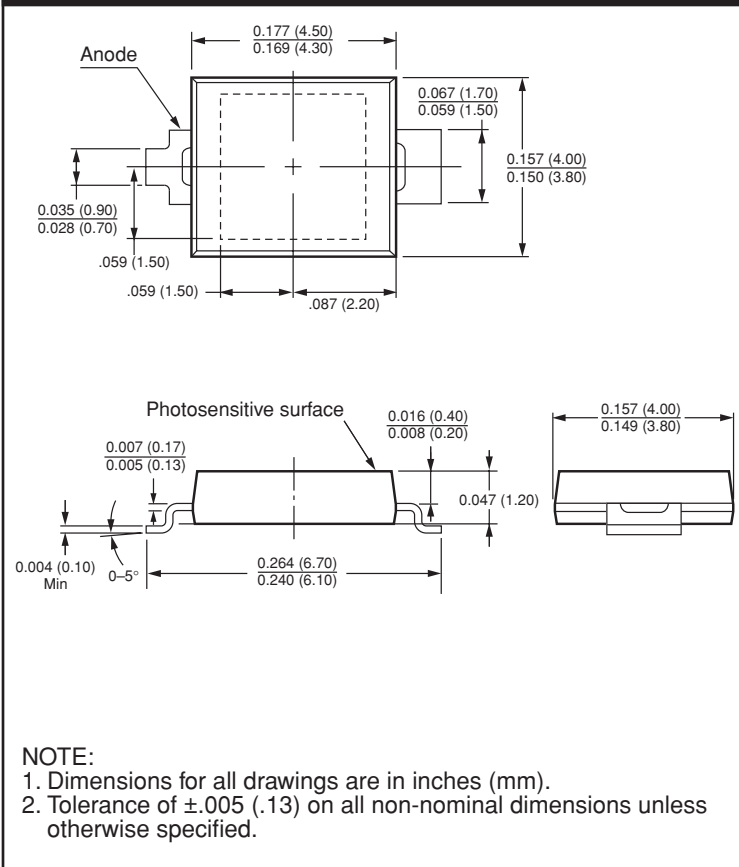
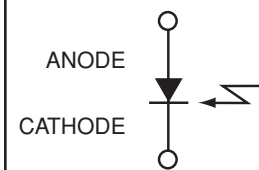

FEATURES

- Daylight Filter
- Surface Mount Packages:
 - QSB34GR for overmount board
 - QSB34ZR for undermount board
- Fast PIN Photodiode
- Wide Reception Angle, 120°
- Large Chip Size = .014 in² (9 mm²)
- High Sensitivity
- Low Capacitance
- Available in 0.470" (12mm) width tape on 7" (178mm) diameter reel; 1,000 units per reel

ABSOLUTE MAXIMUM RATINGS (T_A = 25°C unless otherwise specified)

Parameter	Symbol	Rating	Unit
Operating Temperature	T _{OPR}	-40 to +85	°C
Storage Temperature	T _{STG}	-40 to +85	°C
Soldering Temperature (Reflow) ^(2,3)	T _{SOL-F}	240 for 5 sec	°C
Reverse Voltage	V _R	32	V
Power Dissipation ⁽¹⁾	P _D	150	mW

Notes:

1. Derate power dissipation linearly 2.50 mW/°C above 25°C.
2. Solder iron (15W max temp 260°C for 5 max sec.)
3. Methanol or isopropyl alcohols are recommended as cleaning agents.
4. Light source is an GaAs LED which has a peak emission wavelength of 940 nm.

QSB34GR, QSB34ZR

ELECTRICAL / OPTICAL CHARACTERISTICS ($T_A = 25^\circ\text{C}$ unless otherwise specified)

Parameter	Test Conditions	Symbol	Min	Typ	Max	Units
Reverse Voltage	$I_R = 0.1 \text{ mA}$	V_R	32		—	V
Dark Reverse Current	$V_R = 10 \text{ V}$	$I_{R(D)}$	—		30	nA
Peak Sensitivity	$V_R = 5 \text{ V}$	λ_{PK}		940		nm
Reception Angle @ 1/2 Power		Θ		± 60		Degrees
Photo Current	$E_e = 1.0 \text{ mW/cm}^2$, $V_{CE} = 5 \text{ V}^{(4)}$	I_{PH}	25	37	—	μA
Capacitance	$V_R = 3 \text{ V}$	C		25		pF
Rise Time	$V_R = 10 \text{ V}$, $R_L = 50 \Omega$	t_r		20		ns
Fall Time		t_f		20		ns
Spectral Sensitivity		S_λ		.40		A/W

TYPICAL PERFORMANCE CURVES

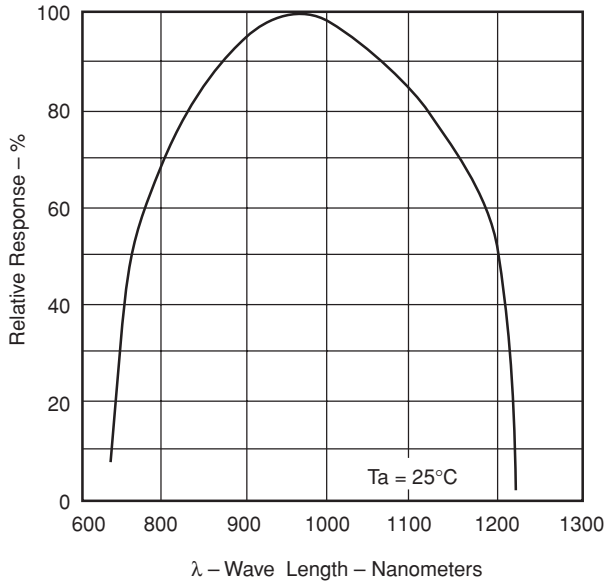

Fig. 1 Relative Spectral Sensitivity vs. Wavelength

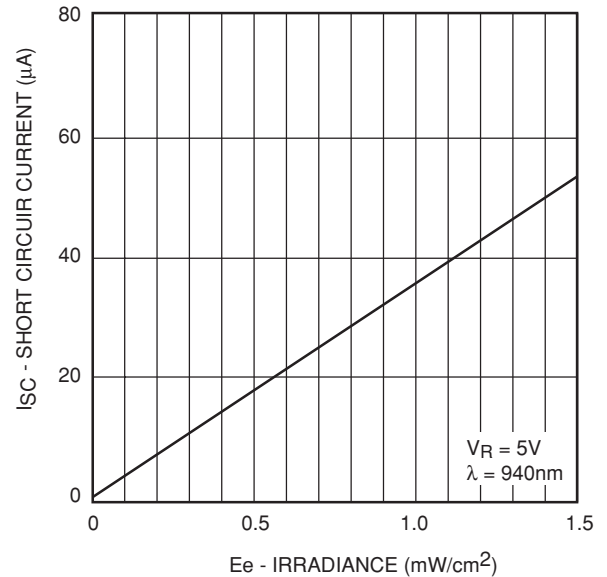

Fig. 2 Short Circuit Current vs. Irradiance

QSB34GR, QSB34ZR

TYPICAL PERFORMANCE CURVES (Cont.)

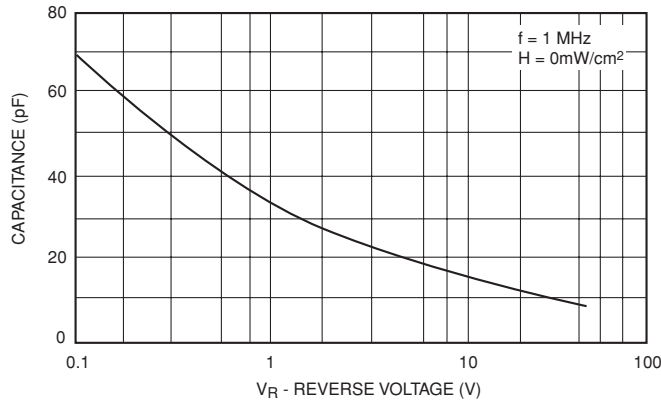

Fig. 3 Capacitance vs. Reverse Voltage

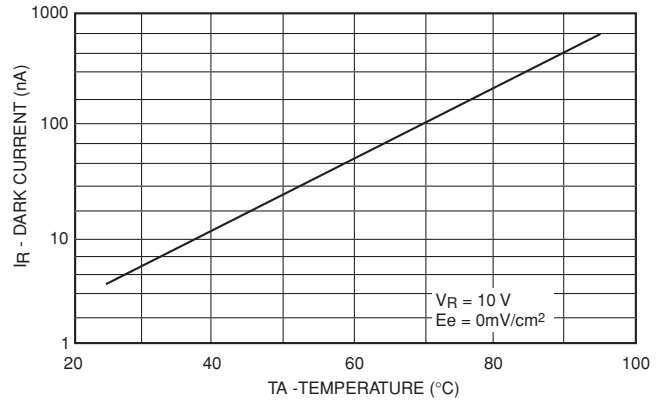

Fig. 4 Dark Current vs. Temperature

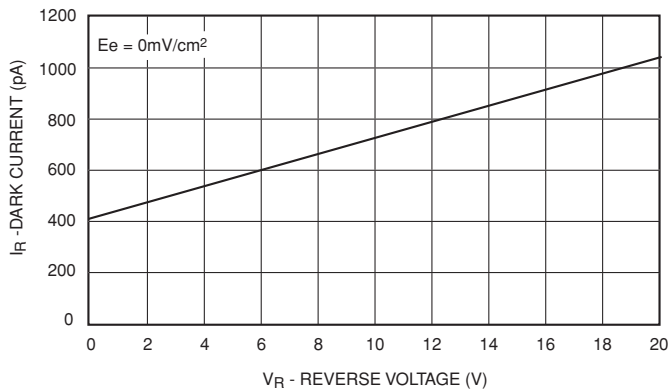

Fig. 5 Dark Current vs. Reverse Voltage

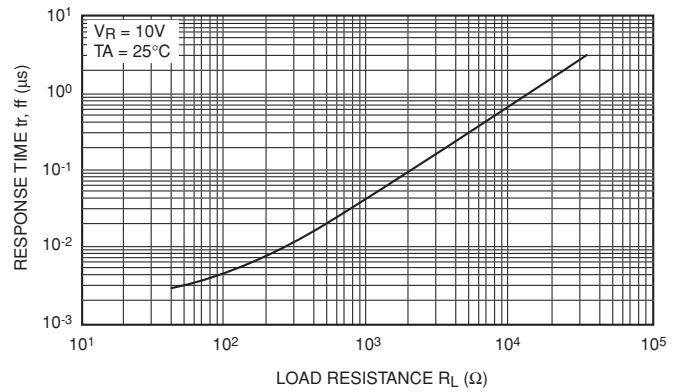
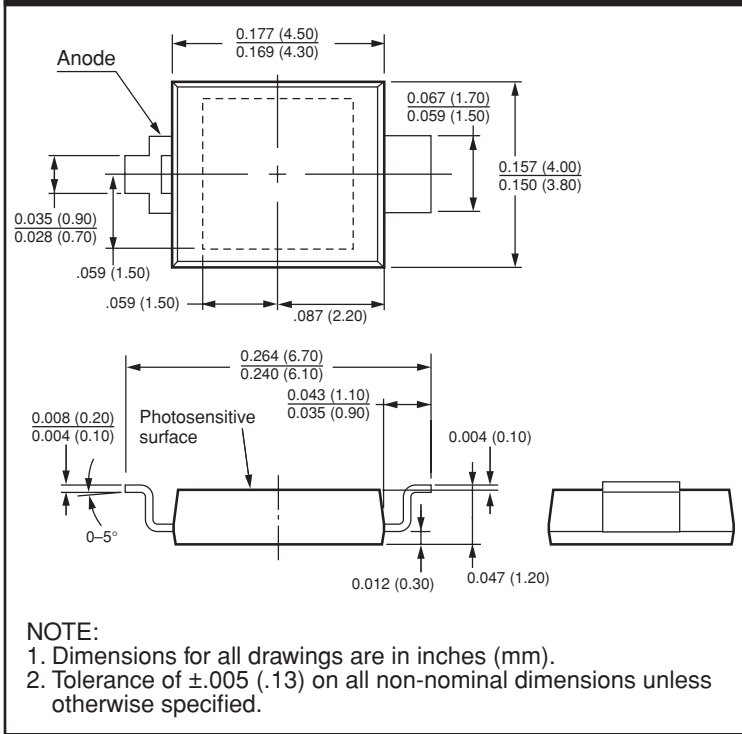

Fig. 6 Response Time vs. Load Resistance

QSB34GR, QSB34ZR

PACKAGE DIMENSIONS, QSB34ZR



**RECOMMENDED SOLDER SCREEN
PATTERN (For Reference Only)**

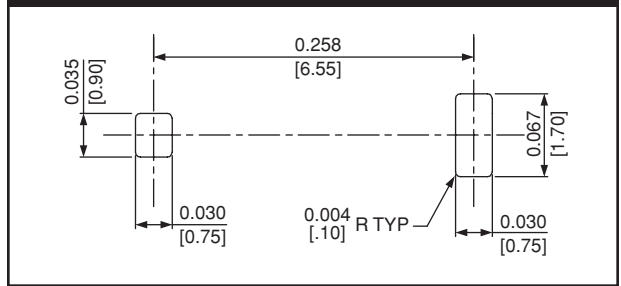

**RECOMMENDED IR REFLOW
SOLDERING PROFILE**

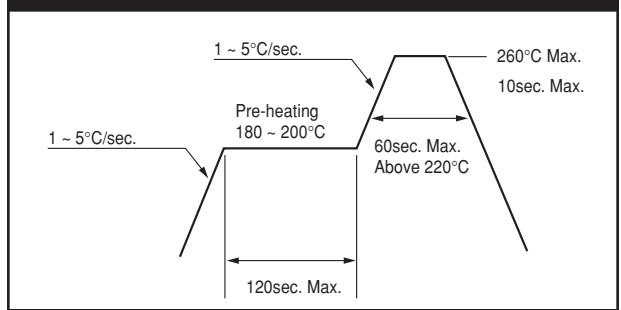

ORDERING INFORMATION

Option	Description
QSB34GR	Gullwing, 1000 units per reel
QSB34ZR	Z-Bend reversed, 1000 units per reel

QSB34GR, QSB34ZR

TAPE & REEL DIMENSIONS

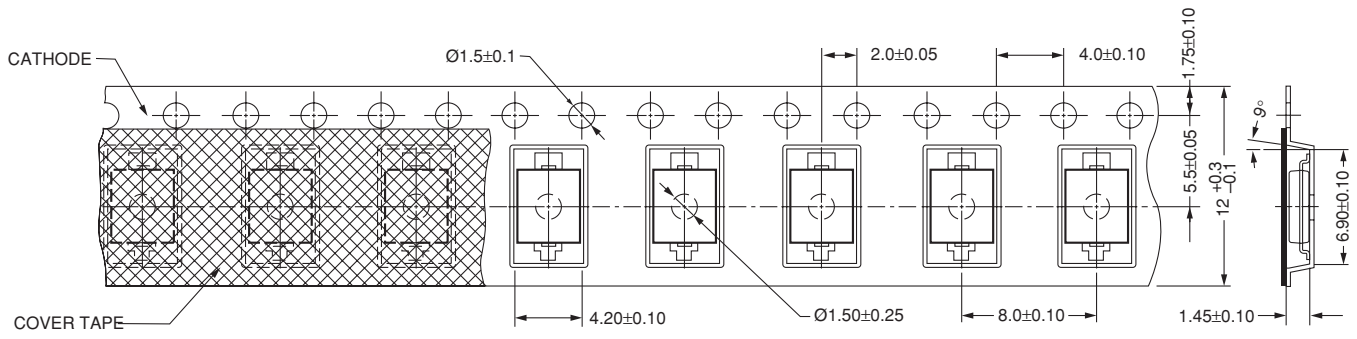
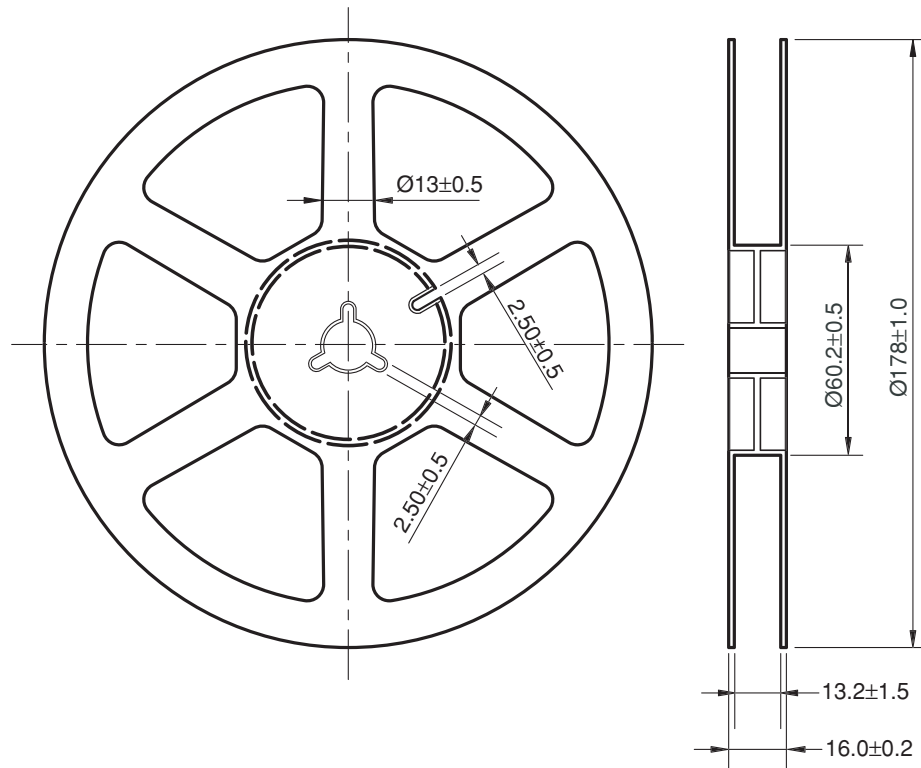

Unit: mm

QSB34GR, QSB34ZR

DISCLAIMER

FAIRCHILD SEMICONDUCTOR RESERVES THE RIGHT TO MAKE CHANGES WITHOUT FURTHER NOTICE TO ANY PRODUCTS HEREIN TO IMPROVE RELIABILITY, FUNCTION OR DESIGN. FAIRCHILD DOES NOT ASSUME ANY LIABILITY ARISING OUT OF THE APPLICATION OR USE OF ANY PRODUCT OR CIRCUIT DESCRIBED HEREIN; NEITHER DOES IT CONVEY ANY LICENSE UNDER ITS PATENT RIGHTS, NOR THE RIGHTS OF OTHERS.

LIFE SUPPORT POLICY

FAIRCHILD'S PRODUCTS ARE NOT AUTHORIZED FOR USE AS CRITICAL COMPONENTS IN LIFE SUPPORT DEVICES OR SYSTEMS WITHOUT THE EXPRESS WRITTEN APPROVAL OF THE PRESIDENT OF FAIRCHILD SEMICONDUCTOR CORPORATION. As used herein:

1. Life support devices or systems are devices or systems which, (a) are intended for surgical implant into the body, or (b) support or sustain life, and (c) whose failure to perform when properly used in accordance with instructions for use provided in the labeling, can be reasonably expected to result in a significant injury of the user.
2. A critical component in any component of a life support device or system whose failure to perform can be reasonably expected to cause the failure of the life support device or system, or to affect its safety or effectiveness.