

# ECONOLINE - DC/DC-Converter

RTS/RTD Series, 2 Watt, SMD (Single & Dual Output)



# RECOM

## Features

- 1kVDC Isolation
- Efficiency to 70%
- UL 94V-0 Package Material
- Toroidal Magnetics
- Internal SMD Construction



## Selection Guide

Part	Input Number (VDC)	Output Voltage (VDC)	Output Voltage (mA)	Efficiency Current (%)
RTS-XX3.3	5, 9, 12, 15, 24	3.3	606	70
RTS-XX05	5, 9, 12, 15, 24	5	400	70
RTS-XX09	5, 9, 12, 15, 24	9	222	75
RTS-XX12	5, 9, 12, 15, 24	12	167	75
RTS-XX15	5, 9, 12, 15, 24	15	133	75
RTS-XX24	5, 9, 12, 15, 24	24	83	78
RTD-XX3.3	5, 9, 12, 15, 24	±3.3	±303	70
RTD-XX05	5, 9, 12, 15, 24	±5	±200	70
RTD-XX09	5, 9, 12, 15, 24	±9	±111	75
RTD-XX12	5, 9, 12, 15, 24	±12	±83	75
RTD-XX15	5, 9, 12, 15, 24	±15	±66	75
RTD-XX24	5, 9, 12, 15, 24	±24	±42	78

## Specifications (Core Operating Area) and Operating Temperature / Derating-Graph

Input Voltage Range		±10%
Output Voltage Accuracy		±5%
Rated Power		2W
Isolation Voltage		1000VDC min.
Isolation Resistance (Viso = 500VDC)		10 GΩ min.
Isolation Capacitance		40pF min./115pF max.
Ripple and Noise (20MHz BW)		150mVp-p max.
Line Voltage Regulation		1.2%/1% of Vin
Load Voltage Regulation (10% to 100% full load)	3.3V output type 5V output type 9V, 12V, 15V output types 24V output type	20% max. 15% max. 10% max. 10% max.
Efficiency at Full Load		70% min.
Short Circuit Protection		1 Second
Operating Temperature Range		-40°C to +71°C
Storage Temperature Range		-55°C to +125°C
Package Weight	Single output types Dual output types	2.1g 2.5g

# ECONOLINE - DC/DC-Converter

RTS/RTD Series, 2 Watt, SMD (Single & Dual Output)



# RECOM

## Package Style and Pinning (mm)

### Dual Output

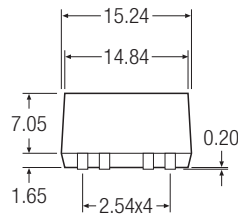
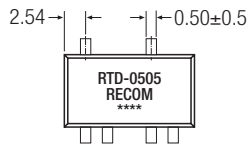

### Single Output

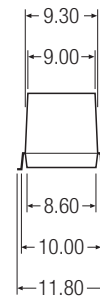
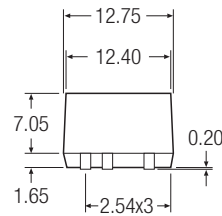
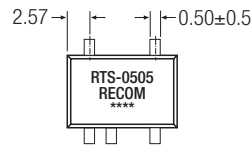

### Recommended Footprint Details

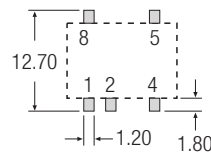
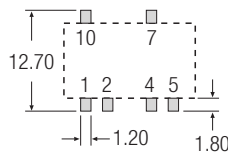

### Pin Connections

Pin #	Single	Dual
1	-Vin	-Vin
2	+Vin	+Vin
4	-Vout	Com
5	+Vout	-Vout
7	No Pin	+Vout
8	NC	No Pin
10	No Pin	NC

NC = No Connection

XX.X ± 0.5 mm  
XX.XX ± 0.25 mm