

# With Button Tactile Switches SOE Series

## FEATURES

1. Minimized surface area.
2. Excellent sealing to resist contamination and flux.
3. Stainless steel click springs provide a sharp tactile sensation and long life.
4. Ideal for setting narrow key pitch.
5. SMT type and reflow-soldering for surface mounting.

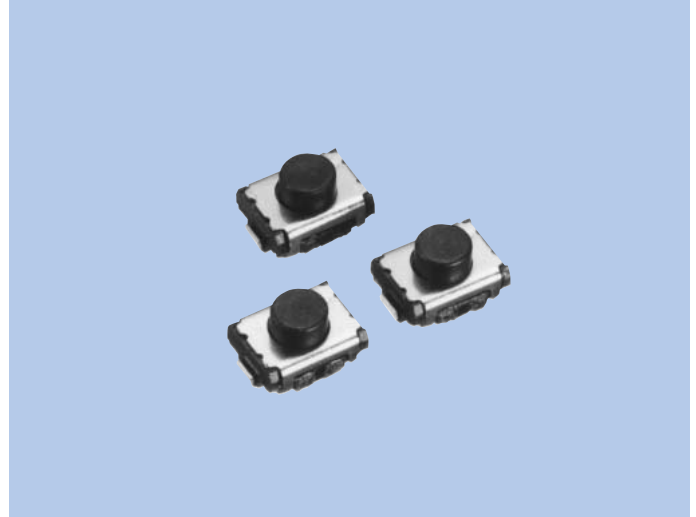

## USES

1. To accommodate the narrow key pitch in new markets such as car audio.

## MODEL NAME CODE

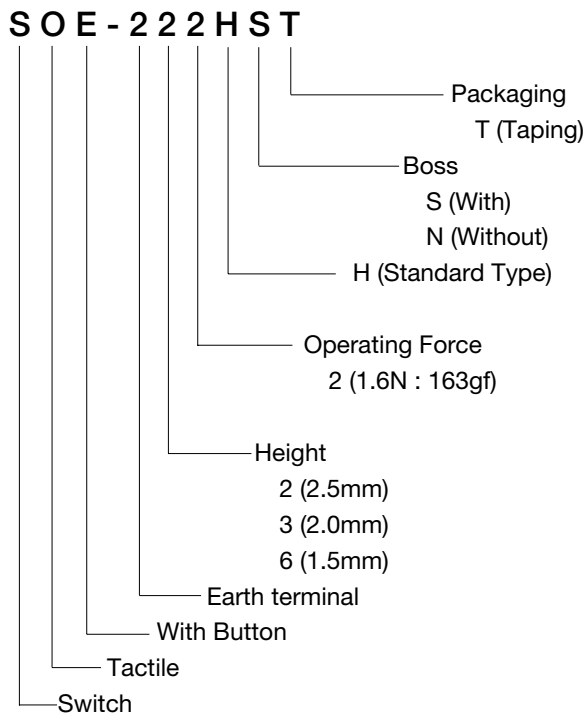

## SPECIFICATIONS

Electrical Characteristics	Rating	50mA, 12V DC
	Contact Resistance	100mΩ or less
	Insulation Resistance	100MΩ or more
	Withstand Voltage	1 minute at 250V
Mechanical Characteristics	Operating Force	1.6N (163gf)
	Life	100,000cycles

## TYPE

Model Name Code	Order Number	Operating Force	Boss	Mounting Height	Pcs
SOE-222HST	R66 6112	1.6N(163gf)	With	2.5mm	4,000
SOE-222HNT	R66 6113	1.6N(163gf)	Without	2.5mm	4,000
SOE-232HST	R66 6114	1.6N(163gf)	With	2.0mm	4,000
SOE-232HNT	R66 6115	1.6N(163gf)	Without	2.0mm	4,000
SOE-262HST	R66 6159	1.6N(163gf)	With	1.5mm	4,000
SOE-262HNT	R66 6160	1.6N(163gf)	Without	1.5mm	4,000

## DIMENSIONS

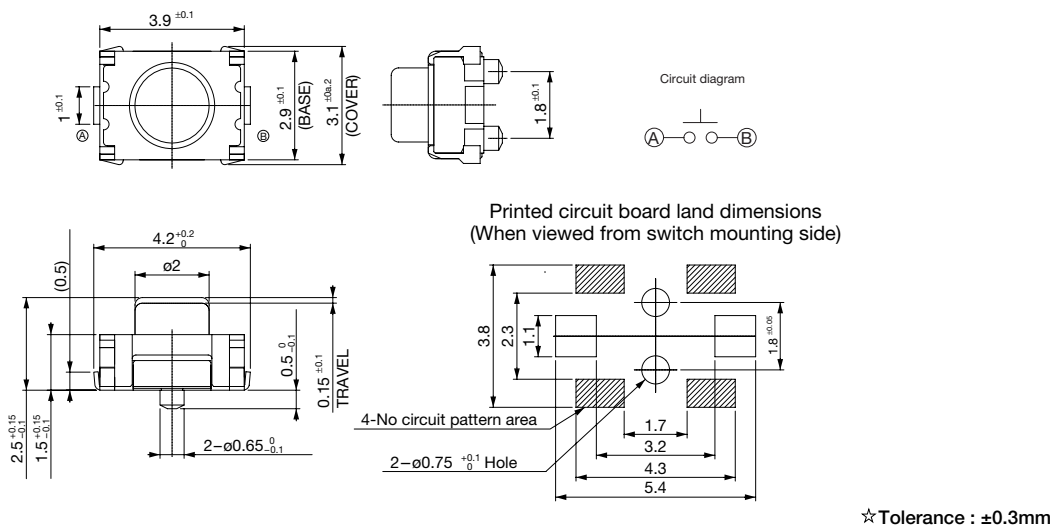

Reel Dimensions

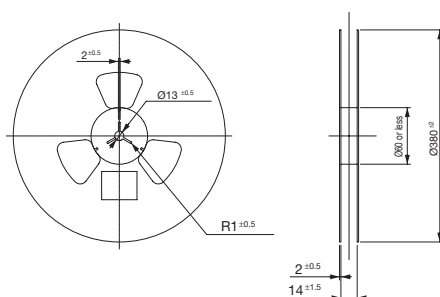

Plastic Tape Dimensions

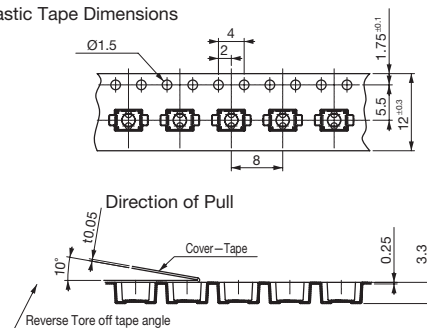

Fig-3 TOLERANCE ±0.1

\*One reel accommodates 4,000 pieces (Ø380).

Unit : mm