

TACT SWITCHES

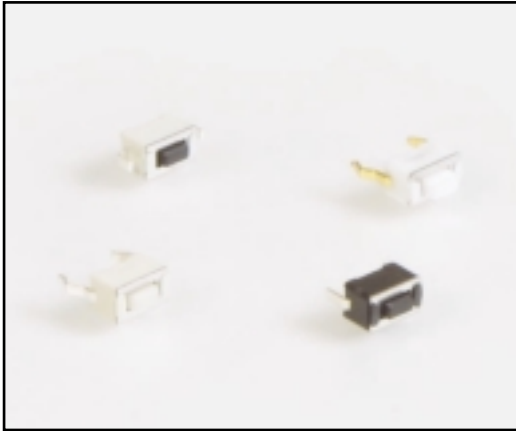

SPECIFICATIONS

Rating: 50mA@50 VDC
 Electrical Life: 100,000 cycles
 Contact Resistance: 100mΩ max., typical @ 2-4 VDC
 100mA for both silver and gold plated contacts
 Insulation Resistance: 1,000Ω min.
 Dielectric Strength: >1,000 V rms at sea level
 Operating Force: 130 ± 50 gf, 180± 50 gf, 260 ± 50 gf

MATERIALS

Housing: 4/6 Nylon
 Actuator: 4/6 Nylon
 Cover: Stainless steel
 Contacts: Silver or Gold Stainless steel
 Terminals: Silver or Gold plated brass

HOW TO ORDER

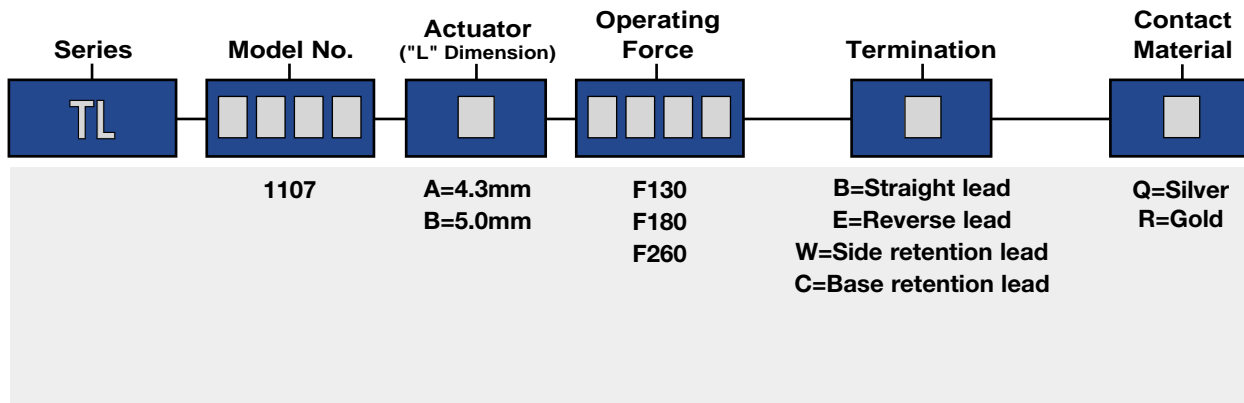

EXAMPLE

TL → 1107 → A → F130 → E → Q

ACTUATOR LENGTH (L)

Model No.	'L' Dim.
TL1107A	4.3mm
TL1107B	5.0mm

OPERATING FORCE

Operating Force
F130 = 130 ± 50gf
F180 = 180 ± 50gf
F260 = 260 ± 50gf

SPECIFICATIONS SUBJECT TO CHANGE WITHOUT NOTICE.

TERMINATION OPTIONS



TL1107
B Termination
(Straight Lead)

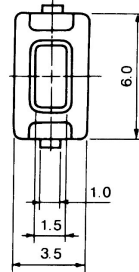
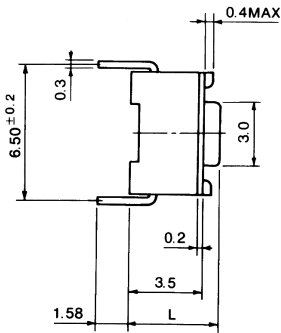

P.C. MOUNTING

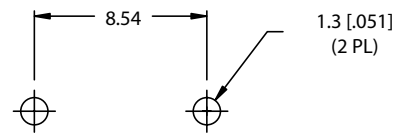

TL1107
E Termination
(Reverse Lead)

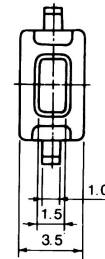
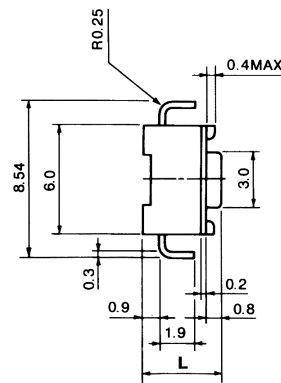

P.C. MOUNTING

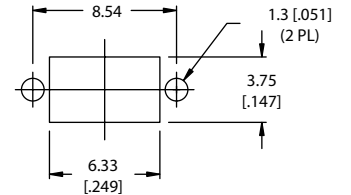

TL1107
W Termination
(Side Retention Lead)

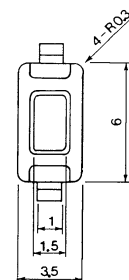
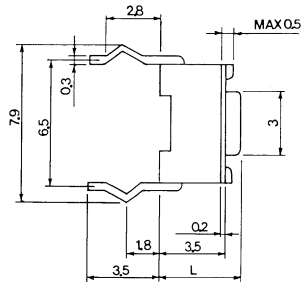

P.C. MOUNTING

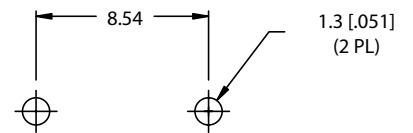

TL1107
C Termination
(Base Retention Lead)

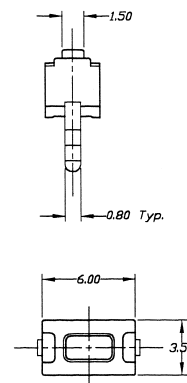
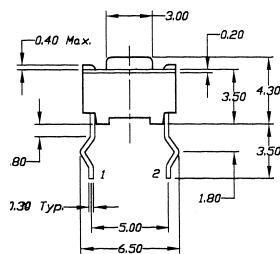

P.C. MOUNTING

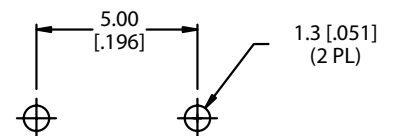

SPECIFICATIONS SUBJECT TO CHANGE WITHOUT NOTICE.