

2.50mm (0.098") PITCH CONNECTOR

Wire-to-Board
Housing

YESH250-NN Series

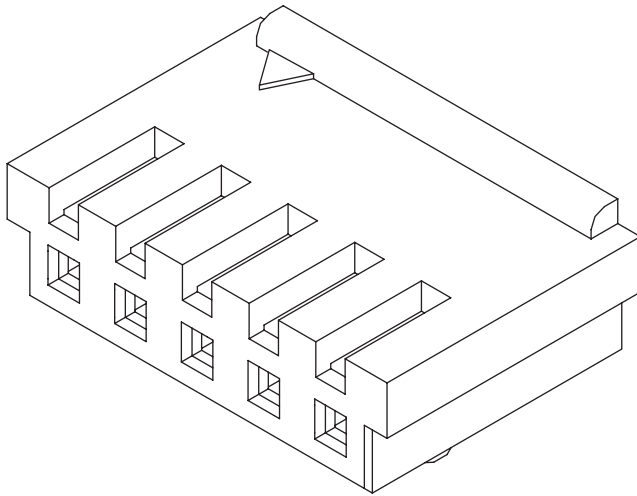

Material

I/NO	DESCRIPTION	TITLE	MATERIAL
1	HOUSING	YESH250	PA66, UL94 V Grade

Available Pin

PARTS NO.	A	B	C
YESH250-02P	6.65	5.35	2.50
YESH250-03P	9.15	7.85	5.00
YESH250-04P	11.65	10.35	7.50
YESH250-05P	14.15	12.85	10.00
YESH250-06P	16.65	15.35	12.50
YESH250-07P	19.15	17.85	15.00
YESH250-08P	21.65	20.35	17.50
YESH250-09P	24.15	22.85	20.00
YESH250-10P	26.65	25.35	22.50
YESH250-11P	29.15	27.85	25.00
YESH250-12P	31.65	30.35	27.50

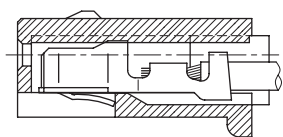
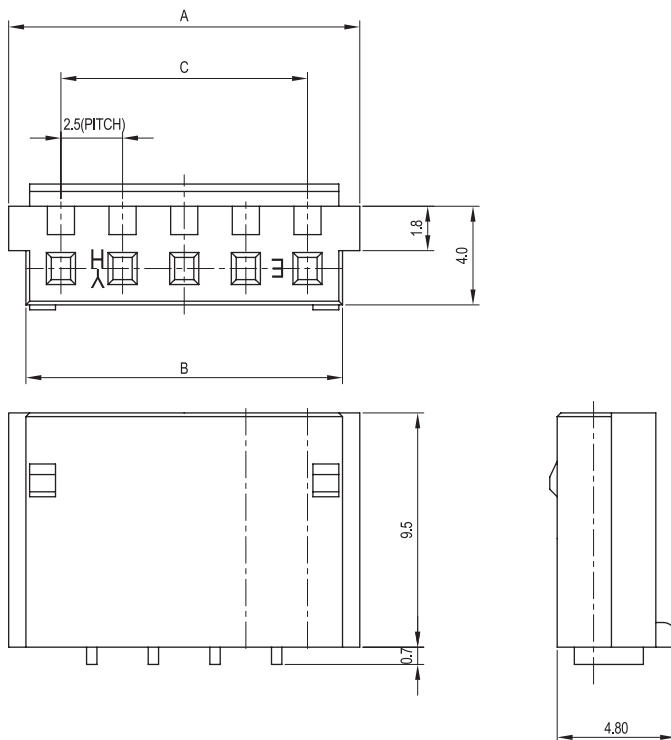

TERMINAL ASSEMBLY DRAWING

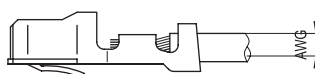

AWG : #22 ~ #28

Specification

ITEM	SPEC
Voltage Rating	AC/DC 250V
Current Rating	AC/DC 3A
Operating Temperature	-25°C ~ +85°C
Contact Resistance	30mΩ MAX
Withstanding Voltage	AC1000V/1min
Insulation Resistance	1000MΩ MIN
Applicable Wire	AWG #22~#28
Applicable P.C.B	-
Applicable FPC/FFC	-
Solder Height	-
Crimp Tensile Strength	-
UL FILE NO	-

Application Terminal : YT250 (147 page)